

Узлы с ручным зажимом

Зажимные узлы VDI
 угловой с.690 прямой с.690

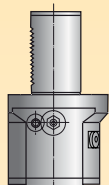

Тип 2080
с.691

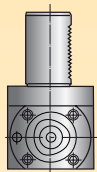
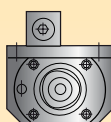

Тип 2085
с.691

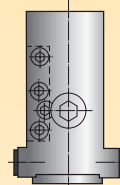

Тип 2035 / 2045 / 2055 / 2065
с.692

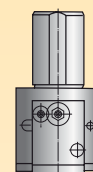

Оправки

391.02
с.696

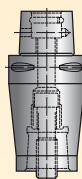

391.01
с.695

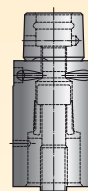

Инструментальные оправки

**WALTER
CAPTO**
Инструмент

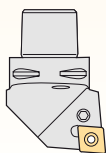

C-ASHA
с.704

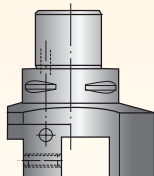

C-ASH
с.703

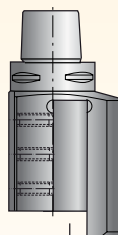

131
с.697

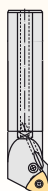
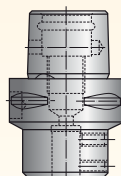

391.14
с.698

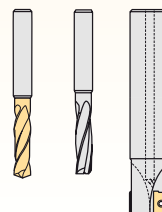
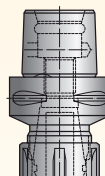

391.20
с.700

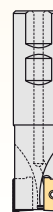
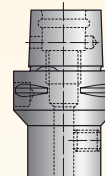

Contents

WALTER CAPTO зажимные узлы и инструментальные оправки

Тип 2000 /
3000
с.692

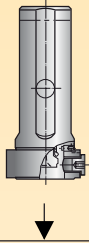

Тип 2090
с.693

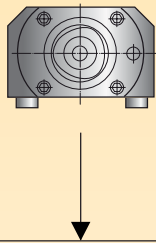

HSK-CAPTO
Тип 390.410
с.694

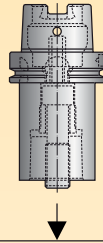

Ведомые
державки
WALTER CAPTO
по запросу



Специальные
зажимные узлы
WALTER CAPTO
по запросу



391.27
с.701

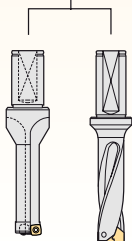
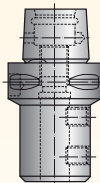

391.60
с.702

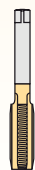
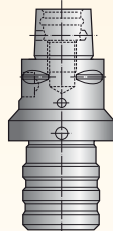

AK 580.C
с.706

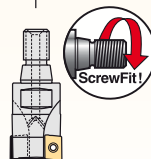
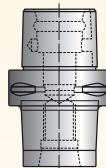

AK 155.8.C
с.705

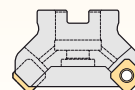
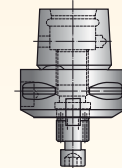

Патрон
WALTER CAPTO с
гидrorасширением
по запросу

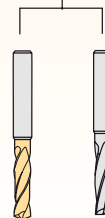

Обзор программы

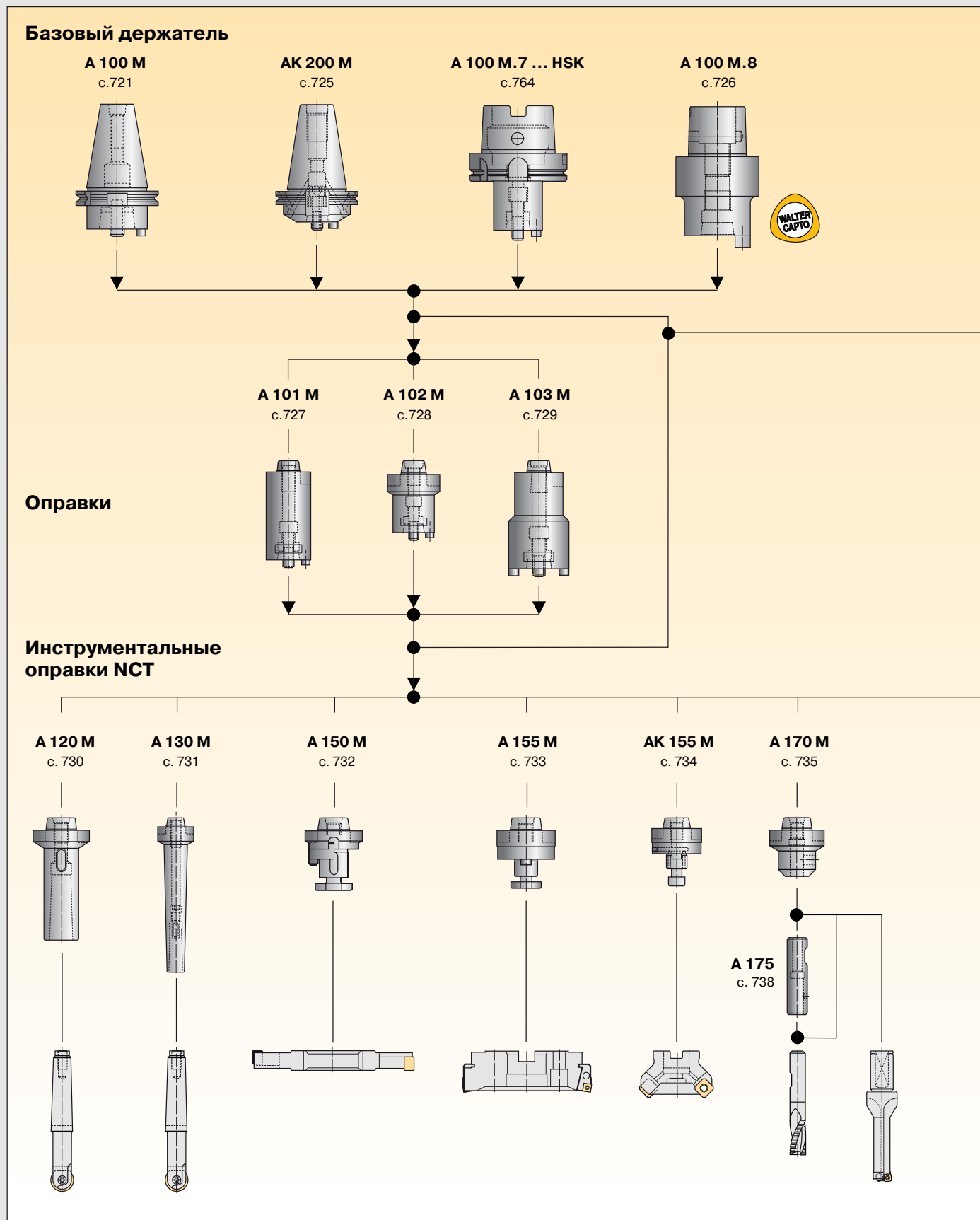

AK 520
с. 748

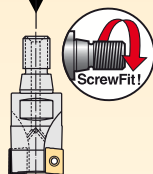
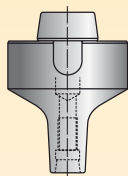

Система резьбовой посадки ScrewFit
приводится на с. 274 или 440

A 171 M
с. 737

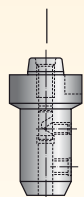

A 201 M
с. 739

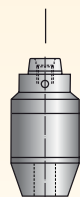

AK 300 M
с. 741

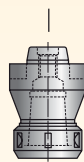

A 305
с. 743

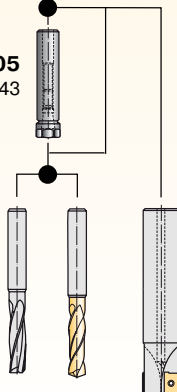

A 320 M
с. 744

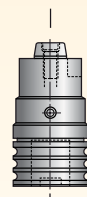

**A 330/
A 331**
с. 772

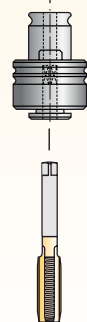

A 340 M
с. 745

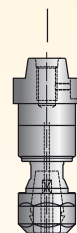

**Инструмент
с соединением
NCT**

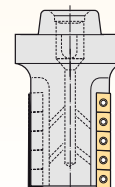

Обзор программы

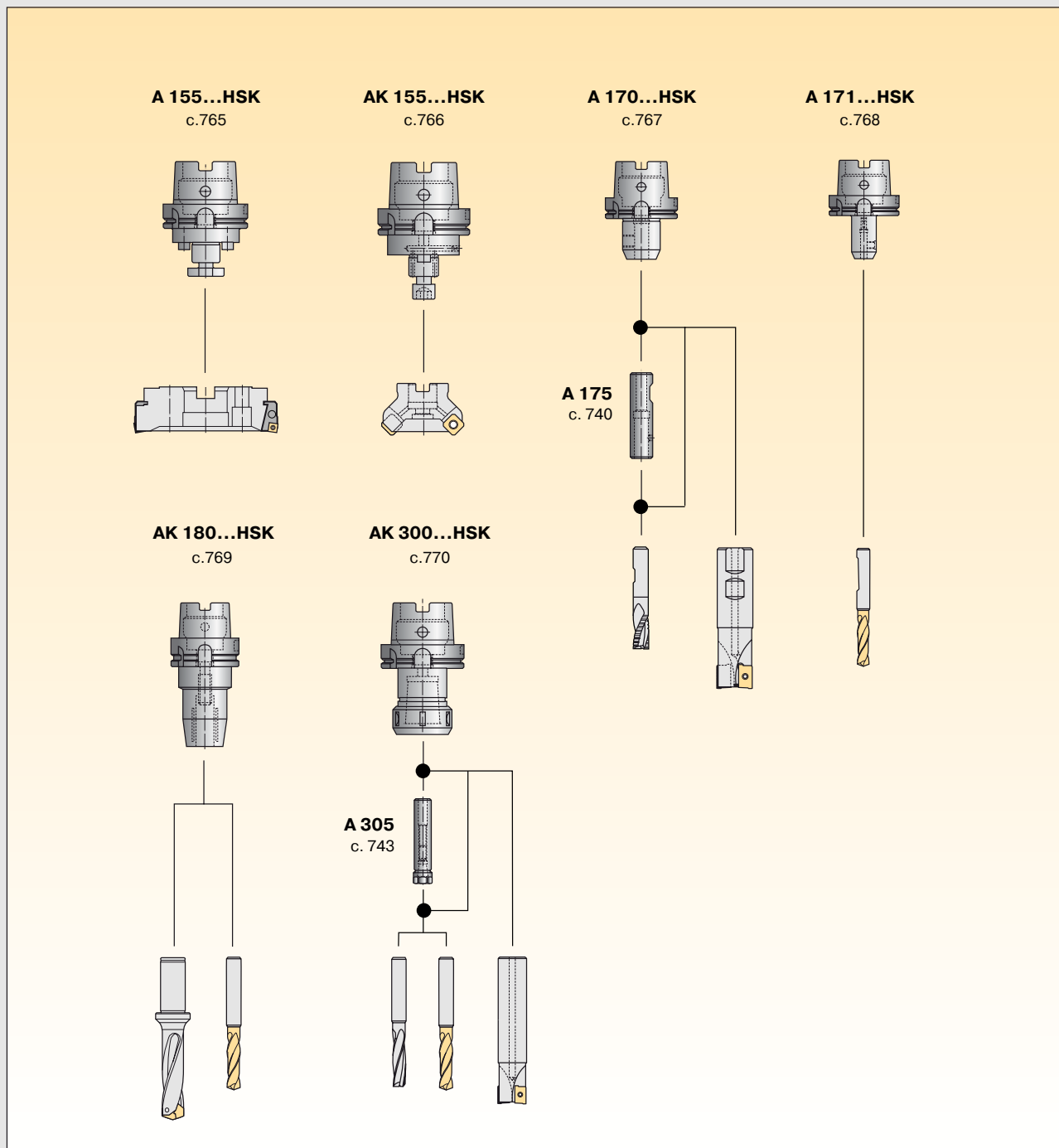

Оправки для термической посадки



A 560
с. 762

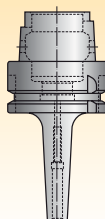

A 570
с. 763

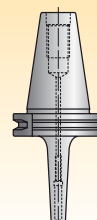

HSK, оправки для термической посадки, оправки для резьбовой посадки ScrewFit

Оправки для насадных инструментов резьбовой посадки ScrewFit

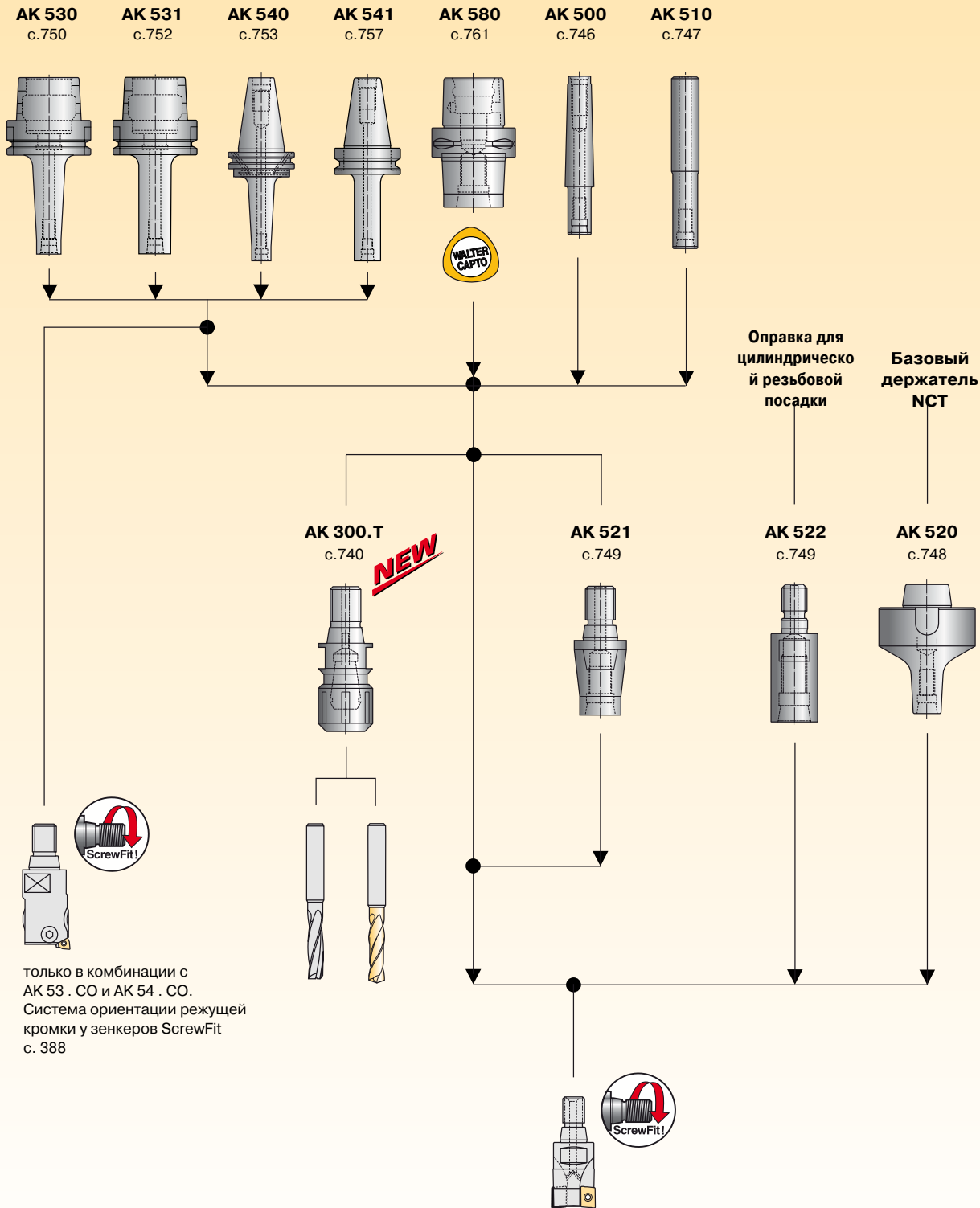

Система резьбовой посадки ScrewFit приводится на с.274 или 440